

Soils Map

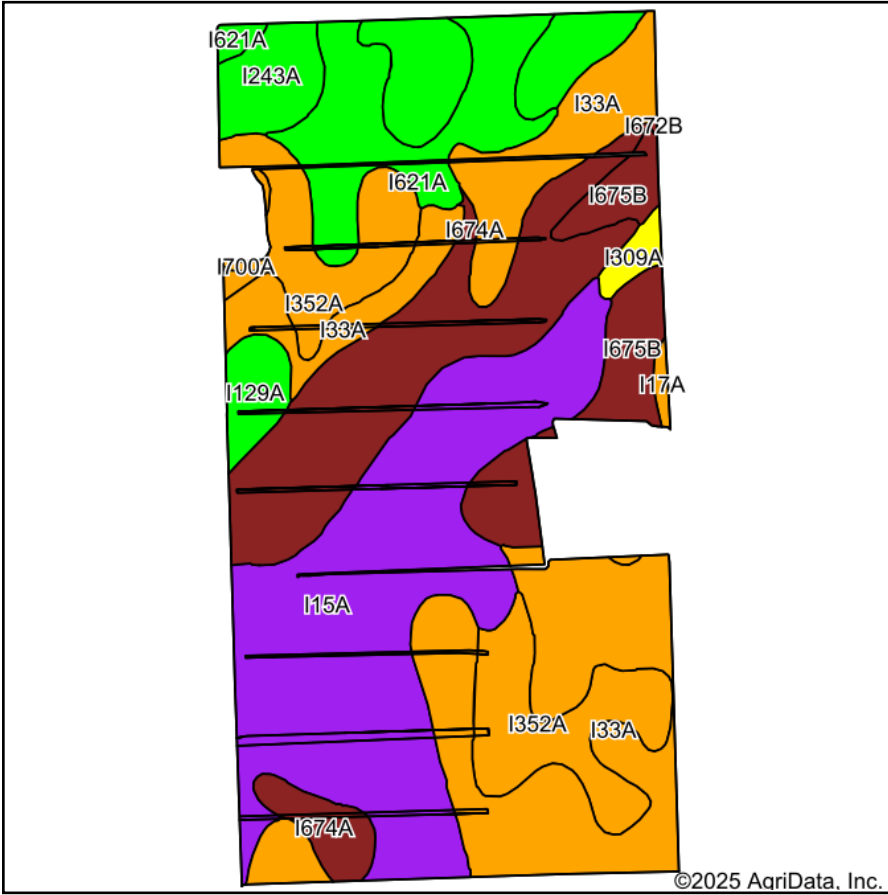

Soils data provided by USDA and NRCS.

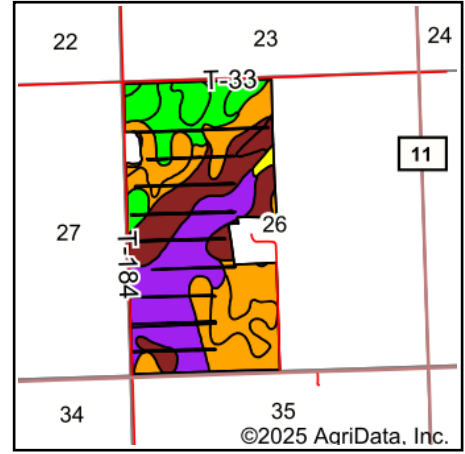

State: **Minnesota**
 County: **Wilkin**
 Location: **26-135N-47W**
 Township: **Mitchell**
 Acres: **296.21**
 Date: **1/10/2025**

Pifer's
 AUCTION & REALTY
 and Land Management

Maps Provided By:



Area Symbol: MN167, Soil Area Version: 21

| Code | Soil Description | Acres | Percent of field | PI Legend | Non-Irr Class | Irr Class | Productivity Index | *n NCCPI Soybeans |
|-------------------------|---|-------|------------------|-----------|---------------|-----------|--------------------|-------------------|
| I15A | Hecla loamy fine sand, 0 to 2 percent slopes | 76.68 | 25.9% | | IVe | IIIe | 50 | 30 |
| I33A | Hilaire loamy fine sand, 0 to 2 percent slopes | 69.00 | 23.3% | | IIIIs | | 70 | 44 |
| I674A | Lohnes sandy loam, 0 to 2 percent slopes | 44.69 | 15.1% | | IIIe | | 37 | 26 |
| I352A | Espelie fine sandy loam, 0 to 1 percent slopes | 33.50 | 11.3% | | IIIW | | 70 | 31 |
| I621A | Clearwater sandy clay loam, 0 to 1 percent slopes | 24.55 | 8.3% | | IIW | | 94 | 49 |
| I243A | Doran clay loam, 0 to 2 percent slopes | 22.08 | 7.5% | | IIc | | 98 | 57 |
| I675B | Lohnes loamy sand, 2 to 6 percent slopes | 16.41 | 5.5% | | VIe | | 37 | 23 |
| I129A | Croke very fine sandy loam, 0 to 2 percent slopes | 5.39 | 1.8% | | IIc | | 85 | 53 |
| I309A | Arveson loam, 0 to 1 percent slopes | 2.26 | 0.8% | | IIW | | 74 | 33 |
| I17A | Foldahl fine sandy loam, loamy till substratum, 0 to 3 percent slopes | 1.00 | 0.3% | | IIs | | 65 | 53 |
| I700A | Rockwell loam, very poorly drained, 0 to 1 percent slopes | 0.56 | 0.2% | | IIIW | | 65 | 41 |
| I672B | Sioux sandy loam, 2 to 6 percent slopes | 0.09 | 0.0% | | VIIs | | 33 | 23 |
| Weighted Average | | | | | 3.24 | *- | 62.4 | *n 36.5 |

*n: The aggregation method is "Weighted Average using all components"

*-: Irr Class weighted average cannot be calculated on the current soils data due to missing data.