

Farmland Auction

25
YEARS
est. 2000

320 +/- Acres • Pembina County, ND

Monday, January 27, 2025 – 11:00 a.m.

Center for Innovation • Grand Forks, ND

OWNERS: Jim Knoff, Mike Gunville & Dan Gunville



Pifer's

877.477.3105

www.pifers.com

INTRODUCTION

Auction Note: This North Dakota Red River Valley property features 320 +/- acres of exceptional cropland for sugar beets, corn, wheat, dry edible beans, and soybeans near Drayton, ND. This property has fantastic Soil Productivity Indexes (SPI) with the majority of them ranging between 86-92! Parcel one has a lease through 2025 and parcel 2 is available for the 2025 crop season! This is a live auction with internet and phone bidding available.

Driving Directions

From I-29 (Exit #187) in Drayton, ND, go 2 miles west on ND Hwy. #66 to 158th Ave. NE and then go 2 miles north. This will bring you to the southwest corner of parcel 1 and the northwest corner of the parcel 2.

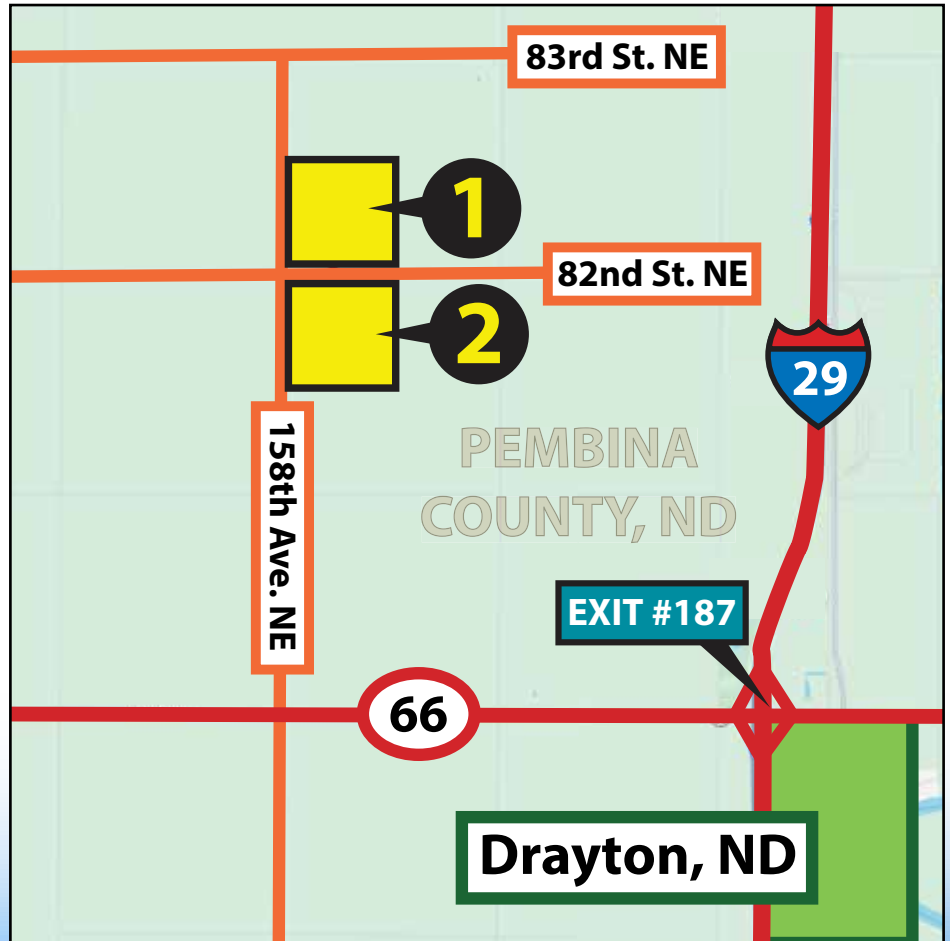

Bob Pifer • 701.371.8538 or bob@pifers.com

Pifer's

997 47th Ave. S, Suite #3 • Grand Forks, ND 58201

OVERALL PROPERTY



PARCEL 1

Acres: 160 +/-

Legal: SW¼ 9-159-51

Crop Acres: 154.35 +/-

Taxes & Drain Specials (2024): \$2,726.54

This parcel features 154.35 +/- acres of excellent cropland with an SPI of 85.3 with much of the soils having an SPI between 90 & 92! Current tenant lease through 2025.

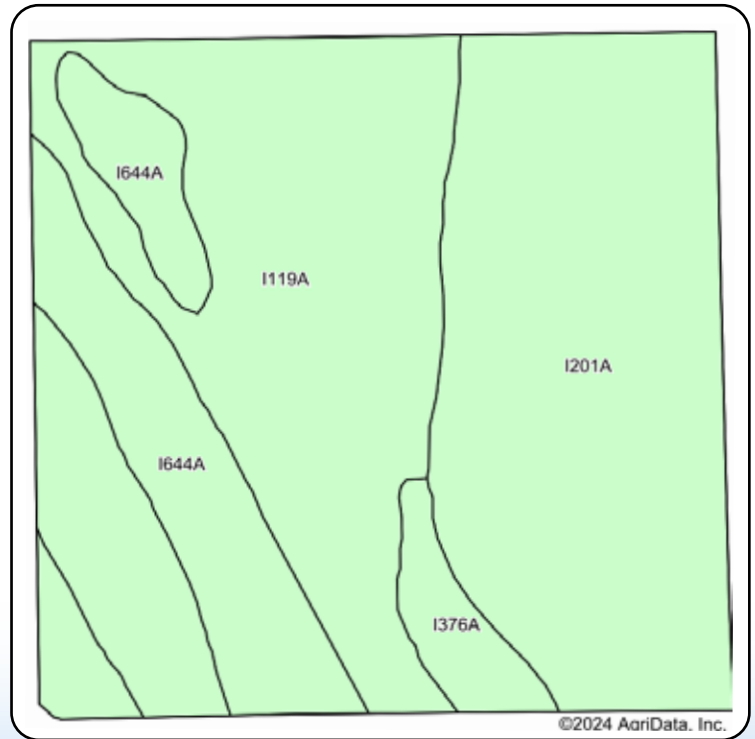

Crop	Base Acres	Yield
Wheat	71.2	63 bu.
Barley	17.8	75 bu.
Total Base Acres: 89.0		

Code	Soil Description	Acres	Percent of field	Non-Irr Class *c	Productivity Index
I119A	Bearden silty clay loam, 0 to 2 percent slopes	61.97	40.2%	Ile	90
I201A	Glyndon silt loam, 0 to 2 percent slopes	59.96	38.8%	Ile	92
I644A	Grano silty clay, plane, 0 to 1 percent slopes	27.13	17.6%	IIIw	63
I376A	Colvin silty clay loam, 0 to 1 percent slopes	5.29	3.4%	IIw	68
Weighted Average					85.3

PARCEL 2

Acres: 160 +/-

Legal: NW¼ 16-159-51

Crop Acres: 151.7 +/-

Taxes & Drain Specials (2024): \$2,733.12

This parcel features 151.7 +/- acres of excellent cropland with an SPI of 78.1 with much of the soils having an SPI between 86 & 92! This parcel has no lease in place and is available for the 2025 crop year.

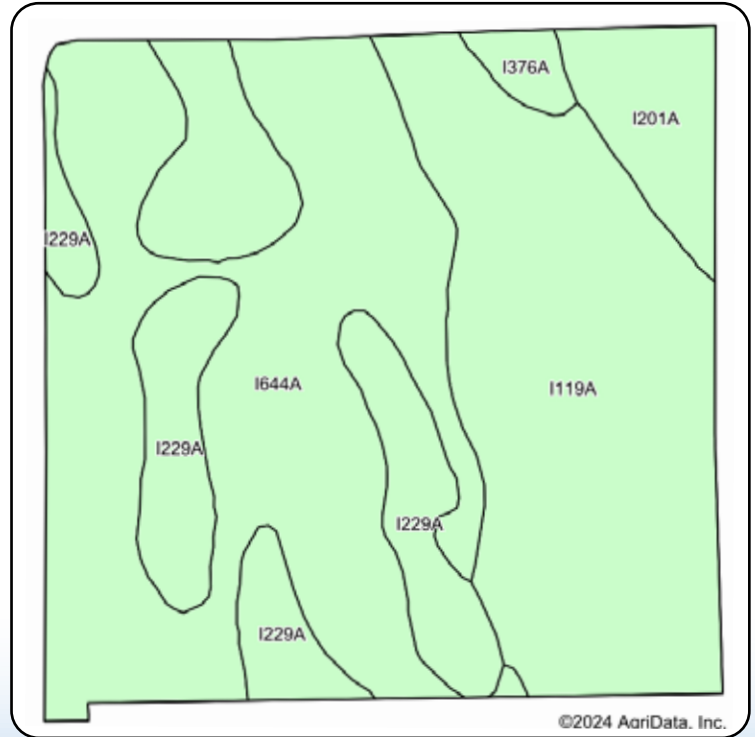

Crop	Base Acres	Yield
Wheat	69.6	63 bu.
Barley	17.4	75 bu.
Total Base Acres: 87.0		

Code	Soil Description	Acres	Percent of field	Non-Irr Class *c	Productivity Index
I644A	Grano silty clay, plane, 0 to 1 percent slopes	62.51	41.1%	IIIw	63
I119A	Bearden silty clay loam, 0 to 2 percent slopes	57.13	37.7%	Ile	90
I229A	Fargo silty clay, 0 to 1 percent slopes	21.66	14.3%	IIw	86
I201A	Glyndon silt loam, 0 to 2 percent slopes	8.30	5.5%	Ile	92
I376A	Colvin silty clay loam, 0 to 1 percent slopes	2.10	1.4%	IIw	68
Weighted Average					78.1

PROPERTY PHOTOS

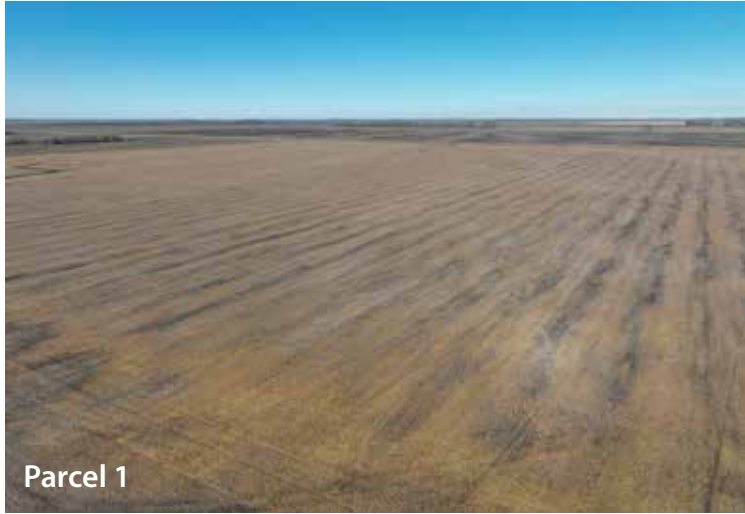

TERMS & CONDITIONS

I. Terms and Conditions of Auction

All bidding is open to the public without regard to a prospective bidder's sex, race, color, religion, or national origin.

A. If you intend to bid on this property, you will be required to provide a cashier's check or personal check in the amount of 10 percent of the purchase price as earnest money on the date of the auction. If you are the successful bidder you will be required to complete and sign a standard Real Estate Purchase Agreement.

B. If you are the highest bidder on any of this property, you will be required to deposit a check with the closing agent who will hold the money in escrow until the closing date. All documentation will be available for your review prior to commencement of the auction. All real estate sales must be closed and the total balance of the purchase price paid on or before 3/13/25. After the auction sale you will be given an appointment date and time with the Closing Agent for a closing date to close the transaction.

II. Bidding Procedures

All bidding is open to the public. You need only to raise your hand and shout out your bid, or instruct any of the ring men to do so on your behalf. Anyone who wishes to bid must first register to obtain a bidder's card at the registration desk.

Retain your bidder number for the duration of the auction. You are responsible for your assigned number. The property is sold when the Auctioneer announces, "sold," identifies the winning bid number and the amount of the bid and the information is recorded by the Auctioneer or his designee. In case of a tie bid, bidding will be reopened between the two tied bidders. The high bid cannot be withdrawn once the Auctioneer determines it to be the winning sale bid.

III. Purchase Agreement, Marketability, Signing Area

At the time the auction is complete, the successful high bidder must sign a standard Real Estate Purchase Agreement to purchase this property for which it was the high bidder. An appointment date to close the transaction will be furnished to the Purchaser after the Purchase Agreement is signed. The transaction must be closed and the money paid on or before March 13, 2025, or the Purchaser will be in default and the earnest money paid herein will be forfeited to the Seller. The Pifer Group Inc, dba Pifer's Auction & Realty and the Seller assumes that the bidders have inspected the property and are satisfied with the conditions of such property and accept that property in an "as is," "where is" condition. The buyer agrees to hold The Pifer Group, Inc. and its client harmless regarding any representation as to the status, zoning, condition and any other material representation regarding this property.

III. Purchase Agreement, Marketability, Signing Area (cont'd)

It is the Purchaser's responsibility to make needed repairs or improvements, if any to bring the property up to necessary state, local, and federal codes. The Pifer Group, Inc. and the sellers obtained information from sources deemed reliable, but do not guarantee its accuracy. Due diligence of property and related information by buyer is strongly recommended.

IV. Forfeiture of Purchase Money Paid Pursuant to the Terms of the Purchase Agreement

Purchaser's failure to close the sale by the closing date due to insufficient funds, or for any other reason will result in the forfeiture of Purchaser's earnest money deposit.

V. Closing

At closing, Buyer will be required to pay the difference between the purchase money deposit and the final selling price. Any fees and closing cost regarding determination of title will be paid by the Purchaser.

VI. Showing of Property

Showing of property will be held by appointment only. **WHETHER OR NOT YOU ACTUALLY INSPECT THE PROPERTY, YOU WILL BE BOUND TO ACCEPT THE PROPERTY "AS IS" AND WITH ALL FAULTS AND DEFECTS AND WITH NO EXPRESSED OR IMPLIED WARRANTY AS TO MARKETABILITY OR THE CONDITION THEREOF.** It will be your responsibility to make any needed repairs, improvements or compliance requirements to bring the property to applicable codes.

VII. Miscellaneous

Conduct of the auction and increments of bidding will be at the discretion of the Auctioneer. The determination by the Auctioneer as to all matters, including the high bidder and the amount of the high bid will be conclusive.

Announcements made by the Auctioneer, Kevin D. Pifer of Pifer's Auction & Realty, will take precedence over said printed matter. For complete prospectus and earnest money requirements contact Pifer's.

This auction bidder's information (including these terms and conditions and any picture or description of any property) is for your information and convenience only. Nothing contained in this information shall be binding on the Seller of the property or the Auctioneer, Pifer's Auction & Realty.

We encourage you to inspect any property you wish to bid on. The seller reserves the right to reject any and all bids.

This sale is managed by Pifer's Auction & Realty, Bob Pifer, ND #905.

Pifer's

25 YEARS 25

est. 2000

877.477.3105



www.pifers.com